

## FLANGE CODE 62 6000 PSI - 90° ELBOW (LONG DROP)

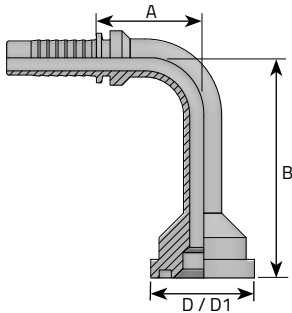

FLANGIA A 90° INTERA SAE 6000 LONG DROP  
 BRIDE 90° 6000 PSI (PIÈCE ENTIER)  
 90° FLANSCHANSCHLUSS 6000 PSI – EINTEILIG  
 BRIDA A 90° 6000 PSI (PIEZA UNICA)

Do Not Include O-Ring / O-Ring Non Compresso /  
 Sans O-Ring / Ohne O-Ring/ Sin O-Ring

| Code         | Tube |        |      | Thread | Dimensions |     |    |     | Pressure |     |
|--------------|------|--------|------|--------|------------|-----|----|-----|----------|-----|
|              | D.N. | Hose   | Diam |        | D          | D1  | B  | A   | Bar      | Psi |
|              | Inch |        | mm   | Inch   | mm         | mm  | mm |     |          |     |
| F90P1212I LD | 20   | 3/4"   | 12   | 3/4"   | 41.3       | 100 | 57 | 350 | 5076     |     |
| F90P1216I LD | 20   | 3/4"   | 12   | 1"     | 47.6       | 137 | 57 | 350 | 5076     |     |
| F90P1616I LD | 25   | 1"     | 16   | 1"     | 47.6       | 120 | 77 | 280 | 4061     |     |
| F90P2020I LD | 32   | 1.1/4" | 20   | 1.1/4" | 54         | 115 | 89 | 210 | 3046     |     |
| F90P2424I LD | 40   | 1.1/2" | 24   | 1.1/2" | 63.5       | 135 | 95 | 185 | 2683     |     |