

FLANGE CODE 62 6000 PSI - 60° ELBOW

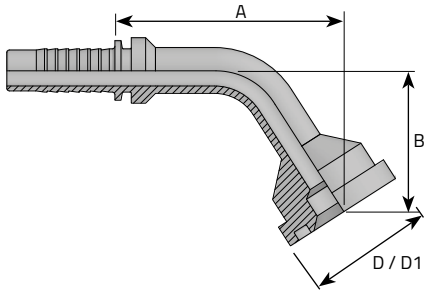

FLANGIA A 60° SAE J518 6000 PSI INTERA
 BRIDE 60° 6000 PSI (PIÈCE ENTIER)
 60° FLANSCHANSCHLUSS 6000 PSI – EINTEILIG
 BRIDA A60° 6000 PSI (PIEZA UNICA)

Do Not Include O-Ring / O-Ring Non Compresso /
 Sans O-Ring / Ohne O-Ring/ Sin O-Ring

Code	Tube			Thread	Dimensions				Pressure	
	D.N.	Hose	Diam		D	D1	B	A	Bar	Psi
	Inch		mm	Inch	mm	mm	mm			
F60P0808I	-8	1/2"	12.8	1/2"	31.7	-	64	415	6019	
F60P0812I	-8	1/2"	12.8	3/4"	41.3	-	69	415	6019	
F60P1008I	-10	5/8"	16	1/2"	31.7	-	60	350	5076	
F60P1012I	-10	5/8"	16	3/4"	41.3	-	66	350	5076	
F60P1208I	-12	3/4"	19	1/2"	31.7	-	64	350	5076	
F60P1212I	-12	3/4"	19	3/4"	41.3	-	70	350	5076	
F60P1216I	-12	3/4"	19	1"	47.6	-	74	350	5076	
F60P1612I	-16	1"	25.4	3/4"	41.3	-	86	280	4061	
F60P1616I	-16	1"	25.4	1"	47.6	-	89	280	4061	
F60P1620I	-16	1"	25.4	1.1/4"	54	-	94	280	4061	
F60P2016I	-20	1.1/4"	31.8	1"	47.6	-	100	210	3046	
F60P2020I	-20	1.1/4"	31.8	1.1/4"	54	-	104	210	3046	
F60P2024I	-20	1.1/4"	31.8	1.1/2"	63.5	-	107	210	3046	
F60P2424I	-24	1.1/2"	38.1	1.1/2"	63.5	-	118	185	2683	
F60P2432I	-24	1.1/2"	38.1	2"	79.4	-	119	185	2683	
F60P3232I	-32	2"	50.8	2"	79.4	-	153	172	2495	