

FLANGE CODE 61- 3000 PSI - 22.5° ELBOW

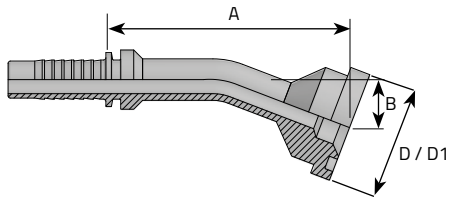

FLANGIA 22.5° SAE J518 3000 PSI INTERA
 BRIDE 22.5° 3000 PSI (PIÈCE ENTIER)
 22.5° FLANSCHANSCHLUSS 3000 PSI – EINTEILIG
 BRIDA A 22.5° 3000 PSI (PIEZA UNICA)

* komatsu flange / Flangia Komatsu/ Bride komatsu /
 Flange komatsu / Brida komatsu

Do Not Include O-Ring / O-Ring Non Compreso /
 Sans O-Ring / Ohne O-Ring/ Sin O-Ring

Code	Tube			Thread	Dimensions				Pressure	
	D.N.	Hose	Diam		D	D1	B	A	Bar	Psi
	Inch	mm	Inch		mm	mm	mm			
F22.5L0808I	-8	1/2"	12.8		1/2"	30.2	-	63	350	5076
* F22.5L0810I	-8	1/2"	12.8		5/8"	34	-	68	350	5076
F22.5L0812I	-8	1/2"	12.8		3/4"	38.1	-	68	350	5076
F22.5L1008I	-10	5/8"	16		1/2"	30.2	-	59	350	5076
* F22.5L1010I	-10	5/8"	16		5/8"	34	-	63	350	5076
F22.5L1012I	-10	5/8"	16		3/4"	38.1	-	63	350	5076
F22.5L1208I	-12	3/4"	19		1/2"	30.2	-	63	350	5076
F22.5L1212I	-12	3/4"	19		3/4"	38.1	-	67	350	5076
F22.5L1216I	-16	3/4"	25.4		1"	44.5	-	70	350	5076
F22.5L1612I	-16	1"	25.4		3/4"	38.1	-	83	280	4061
F22.5L1616I	-16	1"	25.4		1"	44.5	-	86	280	4061
F22.5L1620I	-16	1"	25.4		1.1/4"	50.8	-	90	280	4061
F22.5L2016I	-20	1.1/4"	31.8		1"	44.5	-	96	210	3046
F22.5L2020I	-20	1.1/4"	31.8		1.1/4"	50.8	-	100	210	3046
F22.5L2024I	-20	1.1/4"	31.8		1.1/2"	60.3	-	101	210	3046
F22.5L2424I	-24	1.1/2"	38.1		1.1/2"	60.3	-	112	185	2683
F22.5L2432I	-24	1.1/2"	38.1		2"	71.4	-	123	185	2683
F22.5L3232I	-32	2"	50.8		2"	71.4	-	148	170	2466